

KANSAI UNIVERSITY

Intensive Japanese Language and Culture Course (IJLC) Summer 2019

Notice

Intensive Japanese Language and Culture Course (IJLC) Winter 2020

IJLC Winter 2020 will start from Mid-January and Early February, 2020

Details will be available on our website in July, 2019

http://www.kansai-u.ac.jp/Kokusai/english/from/program.php?id=culture_03

INDEX

Kansai University	1
Japanese Language and Culture Program Preparatory Course (<i>Bekka</i>) ...	1
Intensive Japanese Language and Culture Course (IJLC)	1
Dates.....	1
Eligible Participants	1
Course Contents	2
Number of Participants per Class	2
Campus	2
Class Levels	2
Fees.....	3
Visa.....	4
Application Period	4
Application Procedure	4
Application Documents.....	4
Schedule for Further Procedure	4
Payment of Fee	4
Course Schedule	5
Kansai University International Dormitory	6
Kansai University Minami-Senri International Plaza Dormitory	7
Dormitory Tsukigaoka	8
Student House Shurei-ryo	9
Homestay	10

Kansai University Japanese Language and Culture Program will follow the Japanese laws, guidelines, and other norms concerning the use of personal information(address, name, telephone number or personally identifiable information) provided by the applicant.

When applying for the Course, be sure to refer to the following website for more details about the use of personal information: <http://www.kansai-u.ac.jp/ku-jpn/privacy/index.html>

2019 Summer
Intensive Japanese Language and Culture Course (IJLC)
Course Guide

Kansai University (KU), known as one of the leading universities in Japan with old history of over 130years, is a comprehensive private university with 13 undergraduate, 13 graduate programs, and 3 professional graduate schools. There are over 30,000 students enrolled at the university including more than 900 international students. KU campuses are located in Osaka. They are about an hour train ride away from Kyoto, Kobe and Nara.

Under the new vision for internationalization entitled “Kansai University Global Initiatives” (GI Vision), KU opened the *Bekka* “Japanese Language and Culture Program Preparatory Course” in 2012. This unique course is designed to enhance Japanese language proficiency, media literacy and inter-cultural competency. Currently, over 100 international students from various countries and regions with large portion of students from Asia are enrolled in the course. They are striving to move on to the next stage of education at Japanese universities at both undergraduate and graduate levels.

We are now offering an Intensive Japanese Language and Culture Course (IJLC) in addition to the Preparatory Course (*Bekka*). IJLC will have sessions in summer and winter. In this IJLC, we provide instruction in Japanese as a second language as well as Japanese culture experiences and field trips (e.g. to Kyoto). Participants will learn Japanese language, and understand Japanese culture and society from various perspectives. Another feature of the IJLC is that the participants will have opportunities to interact with KU Japanese students through a variety of activities. In summary, participants will have opportunities to learn communicative Japanese and truly experience the vibrant cities and people of Western Japan.

Dates

Summer 1: Thursday, June 6, 2019 - Thursday, June 27, 2019

Summer 2: Tuesday, July 2, 2019 - Wednesday, July 24, 2019

*Application can be made for above either 1 or 2.

Eligible Participants

Undergraduate or graduate level students

Course Contents

Japanese language classes
Japanese culture experience (e.g., tea ceremony)
Field trips (e.g. to Kyoto)
Interaction with KU students

Number of Participants per Class

Approximately 10-20 students per class
(Class will be cancelled if there are fewer than 10 participants.)

Campus

Kansai University Minami-senri International Plaza

Class Levels: 3 levels

Participants will be placed in an appropriate level of study based on an on-line placement test completed before coming to Japan.

Beginner Class

This is an introductory class for students with a very basic knowledge of Japanese who can read *Hiragana* and *Katakana* and understand basic Japanese such as greetings. This class is equivalent to JLPT N5 level or lower.

Beginner-Intermediate (Lower) Class

This class is for students who can understand and use basic Japanese. This class is equivalent to JLPT N4 - N3 level.

Intermediate (Upper)-Advanced Class

This class is for students who have studied and acquired beginner level of Japanese and have started studying intermediate Japanese. The students should be able to communicate with others using basic Japanese. This class is equivalent to JLPT N2 and higher.

*JLPT: Japanese Language Proficiency Test

*Class will be finalized by the interview after your arrival.

*Before starting IJLC, reading and writing of Hiragana and Katakana and basic Japanese such as greetings needs to be acquired.

*PC or tablet computer and USB flash drive are required.

Fees (per person)

(Unit: Japanese yen)

Accommodation Option	Fees	
	Summer 1	Summer 2
Course fee + Kansai University International Dormitory Single room (shared shower and toilet)	195,000	196,000
Course fee + Kansai University Minami-Senri International Plaza Dormitory Single room (equipped with own bath with toilet)	209,000	210,600
Course fee + Dormitory Tsukigaoka (for female) Twin room, shared shower and toilet	195,000	196,000
Course fee + Student House Shurei-ryo (for male) Single or Twin room, shared shower and toilet -same room charge for either single or twin -applicants cannot choose the room type	195,000	196,000
Course fee + Homestay (Inc. breakfast and dinner) You'll be picked up by your host family after arriving at Minami-Senri International Plaza. The transportation fee for commuting between campus and host family's home is not included in the course fee.	250,000	253,000

*If you arrange accommodations by yourself, please ask us (ijlc@ml.kandai.jp) about fees.

*Overseas travel accident insurance: JPY 16,000

*Short-Term Homestay Fees (Optional) Twin room: JPY 16,000 for 2nights

*The above fee includes:

Japanese language class

Accommodation fee

Transportation fees between the Kansai International Airport (KIX) and each accommodation on arrival and departure

Japanese culture experience (e.g. tea ceremony)

Field trip (e.g. to Kyoto)

Interactions with KU students

Course materials

*The above fee does NOT include:

Airfares /Overseas travel accident insurance/Meals and any other living expenses

Note: Overseas travel accident insurance specified by Kansai University is mandatory for all participants. Its cost will be added to the bill on top of the above fees. The period of insurance coverage conform with the duration of each course designated by Kansai University.

VISA

In case a Visa is required by Ministry of Foreign Affairs to participate in this program, applicants are responsible for obtaining the appropriate Visa. Consult the website of Ministry of Foreign Affairs or the nearest Embassy or the Consulate General of Japan for more information and advice before applying for the course.

http://www.mofa.go.jp/j_info/visit/visa/index.html

Application Period

Summer 1: Monday, December 3, 2018 – Friday, March 15, 2019

Summer 2: Monday, December 3, 2018 – Friday, April 12, 2019

Application Procedure

Email application documents to ijlc@ml.kandai.jp by the end of the application period.

Application Documents

- application form (Form can be downloaded from the URL as follows)
http://www.kansai-u.ac.jp/Kokusai/doc/application_form_IJLC.xls
(Fill in above excel file and send the file by E-mail.)
- Scanned datum of student's ID or Certificate of Enrollment from university (Certification Document issued by the university or other educational institution where the applicant is enrolled or affiliated.)

The Office of the IJLC will inform applicants of placement test within a week from the receipt of application. If applicants don't receive any reply in a week, please inquire ijlc@ml.kandai.jp

Schedule for Further Procedure

Summer 1	Summer 2	
Early April	Early May	Class cancellation decided, announcement for payment and further procedure
Mid-April	Mid-May	Payment deadline, Letter of Acceptance to be sent to applicants after confirmation of the payment
Mid-May	Mid-June	Announcement for pickup time at an airport

Payment of Fee

Accepted applicants will receive an E-mail with guidelines for payment of fees after the application is closed. Follow the guidelines and pay the required fees by the deadline. A money transfer from outside of Japan may take time. Be sure to make the payment well in advance so that it will be completed by the deadline.

As a rule, the course fees once paid will not be refunded.

Course Schedule

※Schedules are subject to change.

Summer1

Day	Date/Period		1st period	2nd period	3rd period	4th period	Lunch Break	5th period	6th period	7th period	8th period
	Class Hours		9:00 - 9:50	10:00 - 10:50	11:00 - 11:50	12:00 - 12:50	12:50 - 13:30	13:30 - 14:20	14:30 - 15:20	15:30 - 16:20	16:30 - 17:20
Day 1	Jun 6	Thu	Arrival - Check in								
Day 2	Jun 7	Fri	Orientation	Japanese	Preliminary Study about Sado	Welcome Party		Senriyama Campus Tour			
Day 3	Jun 8	Sat	Free								
Day 4	Jun 9	Sun	Field Trip 1								
Day 5	Jun 10	Mon	Japanese	Japanese	Japanese	Japanese	CONSULTATION class level (only who wish to switch levels)				
Day 6	Jun 11	Tue	Japanese	Japanese	Japanese	Japanese	FIX class level				
Day 7	Jun 12	Wed	Japanese	Japanese	Japanese	Japanese					
Day 8	Jun 13	Thu	Japanese	Japanese	Japanese	Japanese					
Day 9	Jun 14	Fri	Japanese	Japanese	Japanese	Japanese	Interaction with KU students				
Day 10	Jun 15	Sat	Free								
Day 11	Jun 16	Sun	Field Trip 2								
Day 12	Jun 17	Mon	Japanese	Japanese	Japanese	Japanese		Japanese Culture Experience (Tea Ceremony)			
Day 13	Jun 18	Tue	Japanese	Japanese	Japanese	Japanese					
Day 14	Jun 19	Wed	Japanese	Japanese	Japanese	Japanese					
Day 15	Jun 20	Thu	Japanese	Japanese	Japanese	Japanese					
Day 16	Jun 21	Fri	Japanese	Japanese	Japanese	Japanese		Japanese Culture Experience (Yukata & Bon-odori)			
Day 17	Jun 22	Sat	Free								
Day 18	Jun 23	Sun	Free								
Day 19	Jun 24	Mon	Japanese	Japanese	Japanese	Japanese					
Day 20	Jun 25	Tue	Japanese	Japanese	Japanese	Japanese		Japanese			
Day 21	Jun 26	Wed	Final Presentation		Closing Ceremony	Farewell Party					
Day 22	Jun 27	Thu	Check Out - Departure								

Short-term homestay (For applicants only)

Summer2

Day	Date/Period		1st period	2nd period	3rd period	4th period	Lunch Break	5th period	6th period	7th period	8th period
	Class Hours		9:00 - 9:50	10:00 - 10:50	11:00 - 11:50	12:00 - 12:50	12:50 - 13:30	13:30 - 14:20	14:30 - 15:20	15:30 - 16:20	16:30 - 17:20
Day 1	Jul 2	Tue	Arrival - Check in								
Day 2	Jul 3	Wed	Orientation	reserved period for orientation	Preliminary Study about Sado	Welcome Party		Senriyama Campus Tour			
Day 3	Jul 4	Thu	Japanese	Japanese	Japanese	Japanese	CONSULTATION class level (only who wish to switch levels)				
Day 4	Jul 5	Fri	Japanese	Japanese	Japanese	Japanese	FIX class level				
Day 5	Jul 6	Sat	Free								
Day 6	Jul 7	Sun	Field Trip 1								
Day 7	Jul 8	Mon	Japanese	Japanese	Japanese	Japanese					
Day 8	Jul 9	Tue	Japanese	Japanese	Japanese	Japanese		Japanese Culture Experience (Yukata & Bon-odori)			
Day 9	Jul 10	Wed	Japanese	Japanese	Japanese	Japanese	Interaction with KU students				
Day 10	Jul 11	Thu	Japanese	Japanese	Japanese	Japanese					
Day 11	Jul 12	Fri	Japanese	Japanese	Japanese	Japanese					
Day 12	Jul 13	Sat	Free								
Day 13	Jul 14	Sun	Free								
Day 14	Jul 15	Mon	Free								
Day 15	Jul 16	Tue	Japanese	Japanese	Japanese	Japanese					
Day 16	Jul 17	Wed	Japanese	Japanese	Japanese	Japanese					
Day 17	Jul 18	Thu	Japanese	Japanese	Japanese	Japanese		Japanese Culture Experience (Tea Ceremony)			
Day 18	Jul 19	Fri	Japanese	Japanese	Japanese	Japanese					
Day 19	Jul 20	Sat	Free								
Day 20	Jul 21	Sun	Field Trip 2								
Day 21	Jul 22	Mon	Japanese	Japanese	Japanese	Japanese		Japanese	Japanese		
Day 22	Jul 23	Tue	Final Presentation		Closing Ceremony	Farewell Party					
Day 23	Jul 24	Wed	Check Out - Departure								

Short-term homestay (For applicants only)

○ Kansai University International Dormitory



This is a dormitory for international students located 10 minutes away on foot from Minami-Senri station, and 20 minutes away by bicycle from Kansai University Senriyama campus. Kansai University students, mostly exchange students and full-time-international students are main residents in this dormitory. Resident assistants (RA) will support the daily life of the international

students. All rooms are single occupancy and there are shared kitchen, shower room, washroom, and toilet on each floor. All rooms are equipped with air conditioner/heater.

There are multipurpose room and study room available for the students encouraging active interactions among students. The dormitory is mixed with each floor segregated by gender.

1. Dormitory specifications

Address	3-3 Tsukumodai, Suita-Shi, Osaka 565-0862
Building	5-story building (a residential facility for both males and females)
Establishment	1964 (Renovation work completed in 2008)
Number of rooms	140 rooms
Residence room size	Approximately 8.0 m ²
Security system	Self-locking doors. Manager is available 24 hours a day, 7 days a week.
Meals	No meal plan at this dormitory (Prepare on your own.)
Room furnishings	bed, desk, chair, book shelf, closet, wired and wireless internet LAN, refrigerator, air conditioner, window curtain, linen, desk light, dustbin, drying pole
Unit Amenities	kitchen (cookware, oven toaster, microwave), toilet, washroom, shower room, laundry room (washer & drier), elevator, rental articles (vacuum cleaner, iron, ironing board)
Common area facilities	multipurpose room, study room, bicycle stand
Resident Assistant	3 resident assistants on each floor. (Maximum 15 RAs)

2. Room Layout



- ① desk
- ② bookshelf
- ③ closet
- ④ refrigerator
- ⑤ bed

3. Dormitory Photos

https://www.kansai-u.ac.jp/Kokusai/english/pdf/dormitory_photo.pdf

○ Kansai University Minami-Senri International Plaza Dormitory



This is a dormitory for international students located 5 minutes away on foot from Minami-Senri station, and 15 minutes away by bicycle from Kansai University Senriyama campus. *Bekka* students at Kansai University and exchange students are the main residents in this dormitory and Resident assistants (RA) will support the daily life of the international students. All rooms are single

occupancy and each unit is composed of 6 - 7 rooms, sharing a kitchen, lounge and laundry room, so that students can spend time together. There will be culture exchange events with people from the local community.

1. Dormitory specifications

Address	1-2-20, Satakedai, Suita-shi, Osaka 565-0855
Building	8-story building (a residential facility for both males and females)
Establishment	2012
Number of rooms	165rooms
Residence room size	14 m ²
Security system	Self-locking doors. Manager is available 24 hours a day, 7 days a week.
Meals	No meal plan at this dormitory (Prepare on your own.)
Room furnishings	bed, desk, chair, storage, book shelf, shoe rack, bath with toilet, wired internet LAN ,refrigerator, air conditioner, window curtain, linen, desktop light, dustbin, drying pole
Unit amenities	kitchen(kitchen cookware, oven toaster, microwave, cabinet for tableware), lounge(dining table & chairs, wireless LAN), air conditioner, laundry room(washer & drier) , vacuum cleaner, iron & ironing board, TV, garbage bin
Common area facilities	multi-purpose room (wireless LAN, kitchen), recreation room, Japanese room, bicycle stand
Resident Assistant	RA in each unit (maximum 24 RAs) ※4 units on each floor.

2. Room Layout

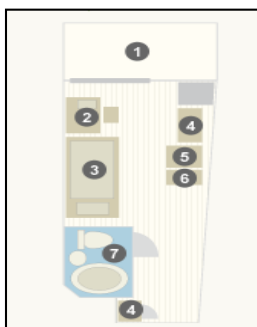

- ① balcony
- ② desk
- ③ bed
- ④ bookshelf
- ⑤ storage space
- ⑥ refrigerator
- ⑦ bath with toilet

3. Dormitory Photos

<http://www.kansai-u.ac.jp/ku-jpn/English/campuslife/introduction/index.html>

○ Dormitory Tsukigaoka



Dormitory Tsukigaoka is a female-only dormitory situated on a hill in a quiet environment. It comes with a great view and is located 15 minutes away on foot from Minami-Senri International Plaza where the IJLC is held. All of the rooms are twin rooms and there are shared facilities such as bathrooms and dining hall. Dormitory

manager is on duty 24 hours a day, 7 days a week and the front door locks automatically for security.

1. Dormitory specifications

Address	25 Senriyama Tsukigaoka, Suita-shi, Osaka 565-0847
Building	4-story building with a lower ground floor (a residential facility for females only)
Capacity	102 person
Residence room size	14 m ²
Security system	Self-locking doors. Manager on duty 24 hours a day, 7 days a week.
Meals	No meal plan at this dormitory (Prepare on your own.)
Room furnishings	Twin room with bed, desk, chair, closet, curtain
Common area facilities	Kitchen, dining room, main bath, shower room, Japanese room, library, lounge, laundry room(washer & drier)

2. Room Layout

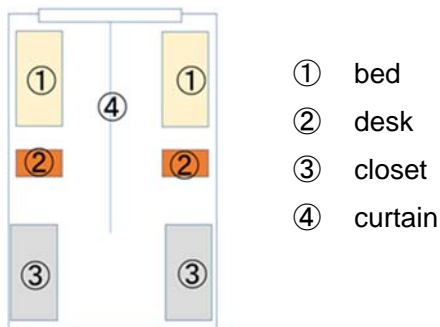

3. Dormitory Photos

<http://www.kansai-u.ac.jp/gakusei/lifestyle/dormitory/moonhill.html>

○Student House Shurei-ryo



Student House Shurei-ryo is a male only dormitory located close by Senriyama campus. Residents share a twin room in principle, as well as other facilities such as shower room and dining hall.

1. Dormitory specifications

Address	3-3 Yamate-cho, Suita-shi, Osaka 564-0073
Building	4-story building(partially 5-story) (a residential facility for male only
Meals	No meal plan at this dormitory (Prepare on your own.)
Room furnishings	Single or Twin room with bed, desk, chair, closet and curtains
Common area facilities	Kitchen, shower, laundry room with washer and dryer, dining hall, Japanese room, library, lounge

2. Room layout



- ① AC
- ② Shelf
- ③ Desk
- ④ Bed
- ⑤ Closet
- ⑥ curtain

3. Dormitory photos

<http://www.kansai-u.ac.jp/gakusei/lifestyle/dormitory/shurei.html>

Homestay Plan



What a wonderful opportunity to experience a Japanese family!!

Staying in a Japanese home will give you a chance to learn about the culture, language and customs from an angle not seen from the outside. It can be tough to make Japanese friends and acquaintances while studying in Japan without a chance to “get your foot in the door” (or *kikkake* as they say here), so wouldn’t you love the chance to make your own home in Japan?

~Some benefits of homestay~

- Improve your Japanese – Use it or lose it! A homestay is the perfect chance to use the Japanese you learned in class every day in real life situations.
- Experience a bit of “everyday life” in Japan – Japan’s culture is lot different than you may expect! A homestay will give you a new perspective on the country and people.
- Make a home away from home – Make friendships you will treasure for life!

★Breakfast and dinner included at home with your family

★Free Wi-Fi if you require it.

★Location approx. 30-60 minutes from the campus
(For students here in Japan.)

Note:

It is your responsibility to pay for the transportation fee.



Center for International Education, Kansai University
1-2-20, Satakedai, Suita-shi, Osaka, 565-0855 Japan
TEL : +81-(0)6-6831-9180 FAX: +81-(0)6-6831-9194

Website:

http://www.kansai-u.ac.jp/Kokusai/english/from/program.php?id=culture_03

Email: ijlc@ml.kandai.jp