

KANSAI UNIVERSITY

Intensive Japanese Language and Culture Course (IJLC)

Summer 2016

INDEX

Kansai University	1
Japanese Language and Culture Program Preparatory Course (<i>Bekka</i>)	1
Intensive Japanese Language and Culture Course (IJLC)	1
Dates	1
Eligible Participants	1
Course Contents	2
Number of Participants per Class	2
Class Levels	2
Course Fees and Accommodations	3
Visa	4
Application Period	4
Application Procedure	5
Application Documents	5
Payment of Fee	5
Course Schedule	6
Kansai University International Dormitory	7
Kansai University Minami-Senri International Plaza International Dormitory...	8
Youth Hostel Shin-Osaka	9
Crystal Hotel Minami-Senri	9

■ Application Forms

Application Form for Intensive Japanese Language and Culture Course (IJLC)

Application Form for Accommodation

Kansai University Japanese Language and Culture Program will follow the Japanese laws, guidelines, and other norms concerning the use of personal information (address, name, telephone number or personally identifiable information) provided by the applicant.

When applying for the Course, be sure to refer to the following website for more details about the use of personal information: <http://www.kansai-u.ac.jp/ku-jpn/privacy/index.html>

2016 Academic Year
Intensive Japanese Language and Culture Course (IJLC)
Course Guide

In 2016, Kansai University (KU) will mark the 130th anniversary of its founding as one of the leading universities in Japan. KU is a comprehensive private university with 13 undergraduate, 13 graduate programs, and 3 professional graduate schools. There are over 30,000 students enrolled at the university including nearly 800 international students. KU has 5 campuses and all are located in Osaka, the largest city in Western Japan. They are about an hour train ride away from Kyoto, Kobe, and Nara.

Under the new vision for internationalization entitled “Kansai University Global Initiatives” (GI Vision), KU opened the *Bekka* “Japanese Language and Culture Program Preparatory Course” in 2012. This unique course is designed to enhance Japanese language proficiency, media literacy and inter-cultural competency. Currently, over 100 international students from various countries and regions with large portion of students from Asia are enrolled in the course. They are striving to move on to the next stage of education at Japanese universities at both undergraduate and graduate levels.

We are now offering an Intensive Japanese Language and Culture Course (IJLC) in addition to the Preparatory Course (*Bekka*). IJLC will have summer session for 3 weeks and winter for 2 weeks. In this IJLC, we provide instruction in Japanese as a second language as well as Japanese culture experiences and field trips to Kyoto and Kobe. Participants will learn Japanese language, and understand Japanese culture and society from various perspectives. Another feature of the IJLC is that the participants will have opportunities to interact with KU Japanese students through a variety of activities.

In summary, participants will have opportunities to learn communicative Japanese and truly experience the vibrant cities and people of Western Japan.

Dates

Sunday, July 3, 2016 - Saturday, July 23, 2016 (21 days)

Eligible Participants

Undergraduate or graduate level students

Course Contents

Japanese language classes
Japanese culture experience (e.g., tea ceremony)
Field trips to Kyoto and Kobe
Interaction with KU students

Number of Participants per class

Approximately 20 students per class
(Class will be cancelled if there are fewer than 10 participants.)

Class Levels: 3 levels

Participants will be placed in an appropriate level of study based on an on-line placement test completed before coming to Japan.

Beginner Class

This is an introductory class for students with a very basic knowledge of Japanese who can read *Hiragana* and *Katakana* and understand basic Japanese such as greetings. This class is equivalent to JLPT※ N5 level or lower.

Beginner-Intermediate (Lower) Class

This class is for students who can understand and use basic Japanese. This class is equivalent to JLPT ※ N4 - N3 level.

Intermediate (Upper)-Advanced Class

This class is for students who have studied and acquired beginner level of Japanese and have started studying intermediate Japanese. The students should be able to communicate with others using basic Japanese. This class is equivalent to JLPT※ N2 and higher.

※JLPT: Japanese Language Proficiency Test

Course Fees and Accommodations

Course Fee (Per person)

Accommodation	Course Fees
1. Kansai University International Dormitory	JPY 189,000
2. Kansai University Minami-Senri International Plaza International Dormitory	JPY 202,000
3. Shin-Osaka Youth Hostel	JPY 225,000
4. Homestay (Inc. breakfast and dinner)	JPY 235,000
5. Crystal Hotel Minami-Senri	JPY 295,000

- Kansai University International Dormitory: Single room (shared shower and toilet)
- Kansai University Minami-Senri International Plaza International Dormitory: Single room (equipped with own bath with toilet)
- Shin-Osaka Youth Hostel: Single-gender dorm (Up to 6 people, shared bath, toilet and kitchen) You may be sharing the room with other hotel guests. You will be asked to move to a room without tatami mats on July 9. The course fee doesn't include the train fares (JPY400 round trip) between the Youth Hostel and Minami-Senri International Plaza.
- Homestay: You'll be picked up by your host family after arriving at Minami-Senri International Plaza. The course fee doesn't include the train fares between host family's house and Minami-Senri International Plaza. The fares are expected to be approximately JPY 7,000 to JPY 14,000 for the duration of the course.
- Crystal Hotel Minami-Senri: Single room (equipped with own bath and toilet)

Short-Term Home stay Fees (Optional)

1 night: Single room: JPY 19,000 / Twin room: JPY 12,000

2 nights: Single room: JPY 23,000 / Twin room: JPY 16,000

※The dates for short-term home stay will be arranged by Kansai University and it is available for 2 nights maximum.

Overseas travel accident insurance (*): JPY 13,000

※The above course fee includes:

Japanese language class

Japanese culture experience (e.g., tea ceremony)

Field trip to Kyoto and Kobe

Interactions with KU students

Course Materials

Accommodation fee (the student's choice of accommodation)

Transportation fees between an airport in Osaka, and assistance by chaperones upon arrival (KU students)

Course Materials

※The above course fee does NOT include:

Airfares

Overseas travel accident insurance (*)

Meals and any other living expenses

(*) Overseas travel accident insurance specified by Kansai University is mandatory for all the participants. Its cost will be added to the bill on top of the above fees.

VISA

A Visa is required by Ministry of Foreign Affairs to participate in this program. Applicants are responsible for obtaining the appropriate Visa. Consult the website of Ministry of Foreign Affairs or the nearest Embassy or the Consulate General of Japan for more information and advice before applying for the course.

http://www.mofa.go.jp/j_info/visit/visa/index.html

Application Period

Friday, 15 January, 2016 – Friday, April 15, 2016

Application Procedure

Send the application documents to Kansai University by the end of the application period by E-mail or mail to the address below. When sending by mail within Japan, use Registered Express Letter. When mailing from outside of Japan, use EMS (Express Mail Service) or another certified or registered postal service. Notify KU when the application documents are posted and include the tracking number.

Application Documents

1. Application Form for Intensive Japanese Language and Culture Course (IJLC)
2. Application Form for Accommodation
3. A copy of student's ID or Certificate of Enrollment from university (Submit the Certification Document that is issued by the university or other educational institution where the applicant is enrolled or affiliated).

Send the application documents to:

E-mail: ijlc@ml.kandai.jp

Mailing Address: Center for International Education, Kansai University
1-2-20 Satakedai, Suita-shi, Osaka 565-0855 Japan

TEL: +81-(0)6-6831-9180 FAX: +81-(0)6-6831-9194

Payment of Fee

Accepted applicants will receive an E-mail with guidelines for payment of fees after the application is closed. Follow the guidelines and pay the required fees in one payment by the deadline.

A money transfer from outside of Japan may take some time. Be sure to make the payment well in advance so that it will be completed by the deadline.

The course fees will not be refunded for any reason once paid.

Course Schedule

This course will be held at Kansai University Minami-Senri International Plaza.

※The schedule is subject to change.

Sunday, July 3, 2016 - Saturday, July 23, 2016

Slot	1st Slot	2nd Slot	3rd Slot	4th Slot	Lunch Break	5th Slot	6th Slot	7th Slot	8th Slot
Day/Time	9:00~9:50	10:00~10:50	11:00~11:50	12:00~12:50	12:50~13:30	13:30~14:20	14:30~15:20	15:30~16:20	16:30~17:30
3-Jul	Sun	Arrival / Check-in / Dorm Orientation							
4-Jul	Mon	Orientation	Japanese Class	Japanese Class	Welcome Ceremony	Campus Tour on Main Campus			
5-Jul	Tue	Japanese Class	Japanese Class	Japanese Class	Japanese Class				
6-Jul	Wed	Japanese Class	Japanese Class	Japanese Class	Japanese Class	Lunch Break	Study about Sado	Experience with KU students	
7-Jul	Thu	Japanese Class	Japanese Class	Japanese Class	Japanese Class	Lunch Break	Japanese Culture Experience (Sado)		
8-Jul	Fri	Japanese Class	Japanese Class	Japanese Class	Japanese Class				
9-Jul	Sat	Day off							
10-Jul	Sun	Field Trip							
11-Jul	Mon	Japanese Class	Japanese Class	Japanese Class	Japanese Class				
12-Jul	Tue	Japanese Class	Japanese Class	Japanese Class	Japanese Class	Lunch Break	Japanese Culture Experience (Yukata & Bon-odori)		
13-Jul	Wed	Japanese Class	Japanese Class	Japanese Class	Japanese Class				
14-Jul	Thu	Japanese Class	Japanese Class	Japanese Class	Japanese Class				
15-Jul	Fri	Japanese Class	Japanese Class	Japanese Class	Japanese Class				
16-Jul	Sat	Day off							
17-Jul	Sun	Day off							
18-Jul	Mon	Field Trip							
19-Jul	Tue	Japanese Class	Japanese Class	Japanese Class	Japanese Class				
20-Jul	Wed	Japanese Class	Japanese Class	Japanese Class	Japanese Class				
21-Jul	Thu	Japanese Class	Japanese Class	Japanese Class	Japanese Class				
22-Jul	Fri	Final Presentation		Closing Ceremony	Farewell Party				
23-Jul	Sat	Check-out / Departure							

Accommodation Details

○ Kansai University International Dormitory



This is a dormitory for international students located 10 minutes away on foot from Minami-Senri station, and 20 minutes away by bicycle from Kansai University Senriyama campus. Kansai University students, mostly exchange students, are the main residents in this dormitory, but KU full time students (including international students) will live in this

dormitory as well. Resident assistants (RA) will support the daily life of the international students. All rooms are single occupancy and there are shared kitchen, shower room, washroom, and toilet on each floor. All rooms are equipped with air conditioner/heater.

There are multipurpose room and study room available for the students encouraging active interactions among students. The dormitory is mixed with each floor segregated by gender.

1. Dormitory specifications

Address	3-3 Tsukumodai, Suita-Shi, Osaka 565-0862
Building	5 story building (a residential facility for both males and females)
Establishment	1964 (Renovation work completed in 2008)
Number of rooms	140 rooms
Residence room size	Approximately 8.0 m ²
Security system	Self-locking doors. Manager is available 24 hours a day, 7 days a week.
Meals	No meal plan at this dormitory (Prepare on your own.)
Room furnishings	bed, desk, chair, book shelf, closet, wired and wireless internet LAN, refrigerator, air conditioner, window curtain, linen, desk light, dustbin, drying pole
Common area facilities	kitchen (cookware, oven toaster, microwave), toilet, washroom, shower room, laundry room (washer & drier), elevator, rental articles (vacuum cleaner, iron, ironing board)
Common area facilities	multipurpose room, study room, bicycle stand
Resident Assistant	3 resident assistants on each floor. (Maximum 15 RAs)

2. Room Layout



- ① desk
- ② bookshelf
- ③ closet
- ④ refrigerator
- ⑤ bed

3. Dormitory Photos

https://www.kansai-u.ac.jp/Kokusai/english/pdf/dormitory_photo.pdf

○ Kansai University Minami-Senri International Plaza International Dormitory



This is a dormitory for international students located 5 minutes away on foot from Minami-Senri station, and 15 minutes away by bicycle from Kansai University Senriyama campus. *Bekka* students at Kansai University and exchange students are the main residents in this dormitory and Resident assistants (RA) will support the daily life of the international students. All rooms are single occupancy and each

unit is composed of 6 - 7 rooms, sharing a kitchen, lounge and laundry room, so that students can spend time together. There will be culture exchange events with people from the local community.

1. Dormitory specifications

Address	1-2-20, Satakedai, Suita-shi, Osaka 565-0855
Building	8 story building (a residential facility for both males and females)
Establishment	2012
Number of rooms	165rooms
Residence room size	14 m ²
Security system	Self-locking doors. Manager is available 24 hours a day, 7 days a week.
Meals	No meal plan at this dormitory (Prepare on your own.)
Room furnishings	bed, desk, chair, storage, book shelf, shoe rack, bath with toilet, wired internet LAN ,refrigerator, air conditioner, window curtain, linen, desktop light, dustbin, drying pole
Unit amenities	kitchen(kitchen cookware, oven toaster, microwave, cabinet for tableware), lounge(dining table & chairs, wireless LAN), air conditioner, laundry room(washer & drier) , vacuum cleaner, iron & ironing board, TV, garbage bin
Common area facilities	multi-purpose room (wireless LAN, kitchen), recreation room, Japanese room, bicycle stand
Resident Assistant	RA in each unit (maximum 24 RAs) ※4 units on each floor.

2. Room Layout

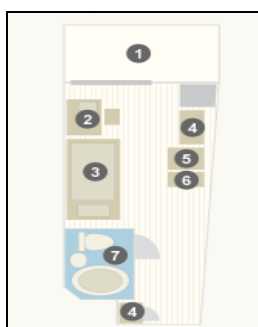

- ① balcony
- ② desk
- ③ bed
- ④ bookshelf
- ⑤ storage space
- ⑥ refrigerator
- ⑦ bath with toilet

3. Dormitory Photos

<http://www.kansai-u.ac.jp/ku-jpn/English/campuslife/introduction/index.html>

○ Youth Hostel Shin-Osaka

<http://osaka-yha.or.jp/shin-osaka-eng/>

○ Crystal Hotel Minami-Senri

<http://www.crystalhotel.jp/facilities.html>

Center for International Education, Kansai University

関西大学 国際教育センター

〒565-0855 大阪府吹田市佐竹台 1-2-20

電話 : +81-(6)-6831-9180 FAX: +81-(6)-6831-9194

Website: <http://www.kansai-u.ac.jp/global/international/index.html>

Email: ijlc@ml.kandai.jp